

## Rough Terrain Trucks RP series

- ▲ Great equipment to move heavy loads.
- ▲ Ergonomic design of the frame to reduce the operation effort.
- ▲ Meanwhile the truck is robust enough for the purpose to work outside such as builders yard, garden centers where there's only an occasional need for moving pallets by forklifts or where no ordinary forklift or even pallet truck can go.
- ▲ The fork is adjustable for special dimension pallet.



**RP1000A**



**RP1250A**

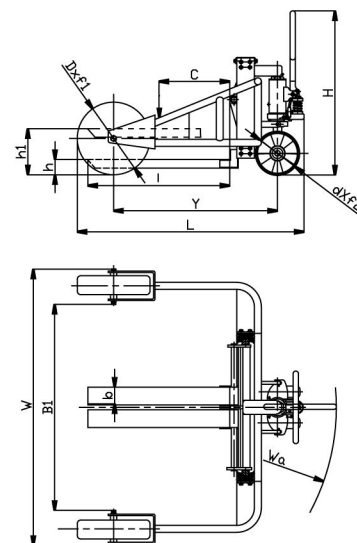

i-Lift No.		1111302	1111303
Model		RP1000A	RP1250A
Rated Capacity	kg(lb.)	1000(2200)	1250(2750)
Max.Fork Height	h1 (mm)(in.)		240(9.4)
Min .Fork Height	h (mm)(in.)		70(2.8)
Fork Length	I (mm)(in.)		800/860(31.5/33.9)
Load Center	C (mm)(in.)		400/430(15.7/17)
Adjustable Fork Width	(mm)(in.)		216-680(8.5-26.8)
Individual Fork Width	b (mm)(in.)	100(4)	120(4.7)
Distance inside the Front Wheel	B1(mm)(in.)		1230(48.4)
Axle Distance between front Wheel and rear steering wheel	Y (mm)(in.)		973(38.3)
front Load Wheel	Dia.×Width (mm)(in.)		Φ568X145(22.4x5.7)
Rear Steering Wheel	Dia.×Width (mm)(in.)		Φ250(10)
Turn Radius	Wa (mm)(in.)		1500(60)
Overall Size	L×W×H (mm)(in.)	1406X1670X1280(55.4x65.7x50.4)	
Net Weight	(kg)(lb.)	210(462)	238(523.6)

**RP1500B**

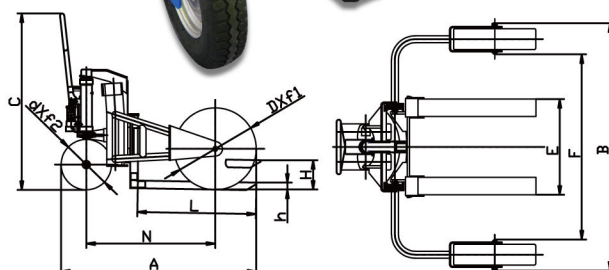

i-Lift No.		1111305
Model		RP1500B
Rated Capacity	kg(lb.)	1500(3300)
Max.Fork Height	H (mm)(in.)	323(12.7)
Min .Fork Height	h (mm)(in.)	53(2.1)
Fork Length	L (mm)(in.)	820(32.3)
Adjustable Fork Width	E (mm)(in.)	316-660(12.4-26)
Distance inside the Front Wheel	F(mm)(in.)	1279(50.4)
Wheelbase	N (mm)(in.)	883(34.8)
Front Load Wheel	DXf1 (mm)(in.)	Φ568X145(22.4x5.7)
Rear Steering Wheel	dXf2 (mm)(in.)	Φ350X100(13.8x4)
Turn Radius	Wa (mm)(in.)	1200(47.2)
Overall Size	A×B×C (mm)(in.)	1350X1711X1220(53.1x67.4x48)