

Digital Load Indicators ID series

- ▲ The i-LIFT load indicator is a mechanical measuring instrument with electronic display.
- ▲ Because of its flexibility the i-LIFT load indicator has universal applications.
- ▲ Whether used as a conventional crane scale or to measure forces, it is the economical choice for various applications. It can be used in conjunction with shackles and hooks.
- ▲ The load indicator is provided with liquid crystal display (LCD) which can tare as well as show either the gross or the net load.
- ▲ It also indicates the overload protection at 110% of the gross weight and the status of the battery.
- ▲ **Conforms to CE safety standard.**

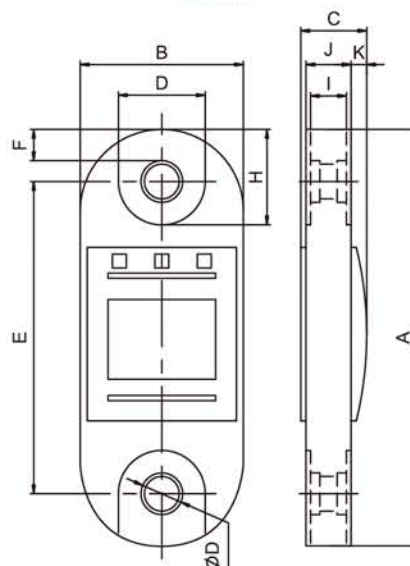

ID1000



i-Lift No.		1210901	1210902	1210903	1210904	1210905	1210906
Model		ID250	ID500	ID1000	ID2000	ID3200	ID6400
Max Capacity	lbs. (kg)	550 (250)	1100 (500)	2200 (1000)	4400 (2000)	7000 (3200)	14000 (6400)
Precision	lbs. (kg)	4 (2)	8 (4)	16 (8)	30 (15)	50 (25)	100 (50)
Indexing Accuracy	lbs. (kg)	1 (0.5)	2 (0.9)	2 (0.9)	10 (4.5)	10 (4.5)	20 (9)
Test Capacity	lbs. (kg)	1100 (500)	2200 (1000)	4400 (2000)	8800 (4000)	14000 (6400)	28000 (12800)
Net Weight	lbs. (kg)		1.1 (0.5)		1.3 (0.6)	1.5 (0.7)	2.3 (1)
Figure dimension in. (mm)	A		8.66 (220)		9.17 (233)	9.57 (234)	10.8 (274)
	B		3.54 (89.9)		3.54 (89.9)	3.81 (96.8)	4.52 (114.8)
	C		1.65 (41.9)			1.89 (48.0)	
	ØD		0.55 (14.0)		0.86 (21.8)	0.86 (21.8)	1.1 (27.9)
	E		7.71 (195.8)		8.15 (207.0)	8.15 (207.0)	8.54 (216.9)
	F		0.47 (11.9)		0.51 (12.7)	0.71 (18.0)	1.14 (29)
	G		1.38 (31.5)		1.77 (45.0)	1.77 (45.0)	2.13 (54.1)
	H		1.43 (36.3)		1.83 (46.5)	2.2 (55.9)	2.75 (69.9)
	I		0.62 (15.7)			1.0 (25.4)	
	J		1.06 (26.9)			1.3 (33.0)	
	K		0.4 (10.2)			0.4 (10.2)	

i-LIFT load indicator feature include, high accuracy, lightweight design, easy to read display, easy to use, excellent quality, sturdy design, retains the maximum value to memory.