

Welding Hook WH series

- The welding hooks are universal attachments for use on trucks, excavators, spreader beams, and low loaders, etc.
- The hook can be welded without any special preparation, e.g. pre-warming.
- The forged safety latch has high lateral stability and an ergonomic form.
- The hook and safety latch are epoxy resin powder coated for added corrosion protection.



WH10

WH30

added corrosion protection.

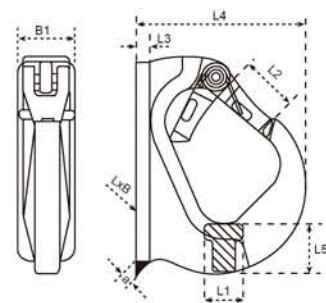

i-Lift No.		2313501	2313502	2313503	2313504
Model		WH10	WH30	WH50	WH80
Capacity	(kg)	1000	3000	5000	8000
Welding Size	a (mm)	4	5	5	7
Dimensions (mm)	L x B	90 x 25	130 x 35	160 x 45	170 x 50
	L1	17	24	30	40
	L2	24	29	37	47
	L3	6	8	10	
	L4	76	105	132	138
	L5	22	28	47	50
Weight	(kg)	0.4	1.25	2.35	3.6

Pulley Block PB series

- Used to change the direction of a rope with a cast steel sheave.
- Manufactured in accordance with European Standard EN 13157: 2003, and the machinery Directive 98/37/EC.
- One side of the pulley blocks is hinged and can be opened for easy and quick positioning of the rope on the sheave.
- Swinging the hook in the direction of pull securely locks the block.
- The sheaves are high quality cast steel and have machined grooves.



PB10

PB64

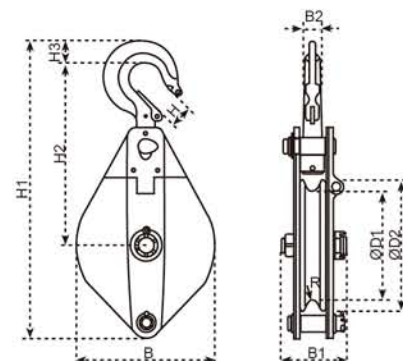

i-lift No.		2313701	2313702	2313703	2313704
Model		PB10	PB20	PB32	PB64
Working Load	(tonne)	1	2	3.2	6.4
Hook Hatch	H (mm)	23	27	31	42
Rope Diameter	(mm)	Ø7	Ø13	Ø15	Ø18
Dimensions(mm)	B	118	119	230	270
	B1	76	92	108	116
	B2	17	24	28	35
	H1	305	425	496	655
	H2	200	263	295	375
	H3	23	30	40	47
	D1	85	150	180	210
	D2	105	190	220	260
	R	4	7	9	10
Weight	(kg)	3.3	8.9	15.5	26.5