

High Lift Scissor Truck JL / JE series

New design with larger piston offer you real 1000kg and 1500kg capacity

- ▲ **Character:** Extremely easy to pump and light make this unit very suitable as combined hand pallet truck and lift table.
- ▲ Quick-lift as standard with automatic transfer to normal lifting with loads over 150kg.
- ▲ Automatic descending speed control by a uniquely hydraulic valve, the descending speed always keeps same regardless the truck with or without load. It will prevent cargo damage from fast descending.
- ▲ Front support legs and adjustable stabilizers extended to the floor automatically when the forks reach a height of 420mm, to ensure maximum stability and optimum braking.
- ▲ Ergonomic warm handle offers you simple and comfortable operation.
- ▲ Heavy duty design: 4mm steel plate fork frame and larger lift piston ensure the truck to reach rated capacity.
- ▲ **Conforms to EN1757-4.**

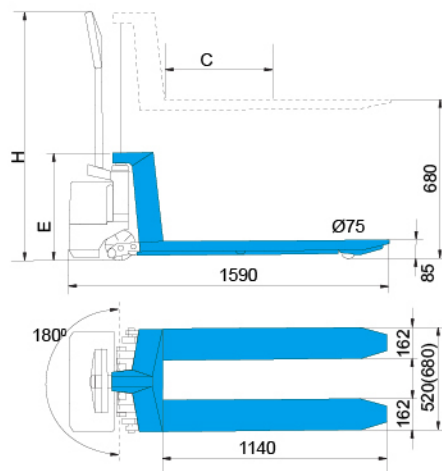
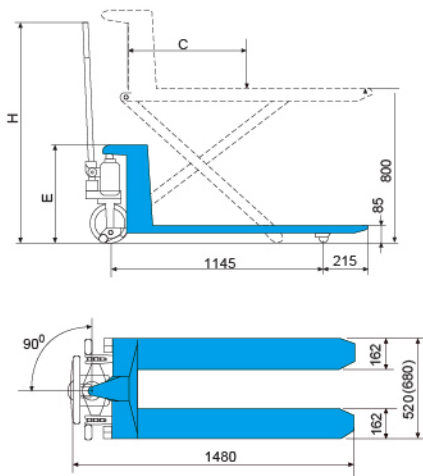

i-Lift No.		1410601	1410602	1410603	1410604	1410605	1410606	1410607	1410608
Model		JL5210	JE5210	JL6810	JE6810	JL5215	JE5215	JL6815	JE6815
Capacity		kg(lb.) 1000(2200)				1500(3300)			
Max. Fork Height		mm(in.) 800(31.5)							
Min. Fork Height		mm(in.) 85(3.3)							
Fork Overall Width		mm(in.) 520(20.5)		680(26.8)		520(20.5)		680(26.8)	
Fork Length		mm(in.) 1140(44.9)				1100(44)			
Dimension	C	mm(in.) 600(23.6)				560(22)	600(23.6)	560(22)	600(23.6)
	E	mm(in.) 530(20.9)							
	H	mm(in.) 1250(49.2)							
Battery (Ah/V)		—	70/12	—	70/12	—	70/12	—	70/12
Battery Charger (A/V)		—	8/12	—	8/12	—	8/12	—	8/12
Net Weight		kg(lb.) 105(231)	140(308)	112(246.4)	147(323.4)	118(259.6)	149(327.8)	125(275)	157(345.4)