

## Swift Drum Loader/Unloader DTF

- ▲ Easily glides over pallet to quickly load or unload 30 or 55-gallon drums, Grabs drums from the middle of a standard pallet with a drum clawgrab, raises the drums up, and redistributes them throughout the facility.
- ▲ Also removes drums from the corner of containment skids. Highly maneuverable unit features two poly wheel and two poly caster.

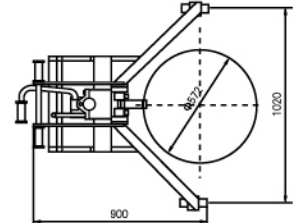
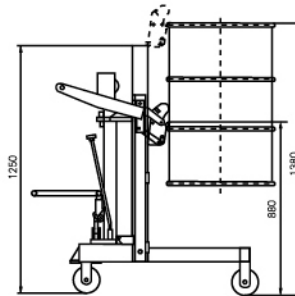

i-Lift No.		1710701
Model		DTF450
Lifting Capacity	kg(lb.)	450(990)
Lifting Height	mm(in.)	500(20)
Lifting Per Stroke	mm(in.)	11.6(0.5)
Drum Size		572mm (22.5" Diameter), 210Lifters (55 gallon)
Net Weight	kb(lb.)	101(222.2)

## Ergonomic Drum Handler DT

### Heavy-Duty

- ▲ Ergonomically lifts, transports, and places poly, steel, or fiber drums on or off pallets.
- ▲ A spring-loaded clamp securely holds any rimmed drum.
- ▲ It has swivel steering wheels for easy positioning and precision roller bearing load wheels for maximum stability.
- ▲ Legs adjust for different pallet. Handles 55-, 85-gallon drums.



Adjustable leg

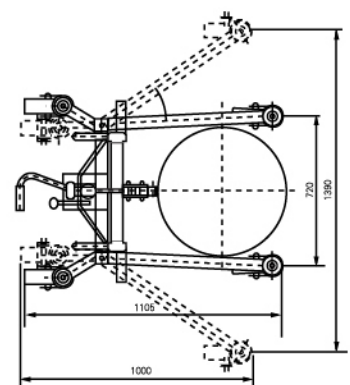
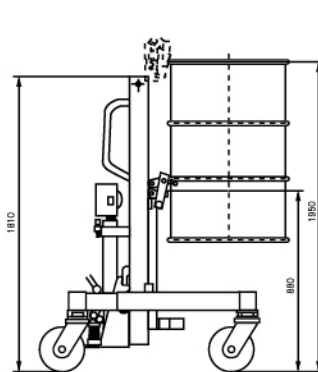

i-Lift No.		1710702
Model		DT400
Lifting Capacity	kg(lb.)	400(880)
Lifting Height	mm(in.)	1070(42.1)
Lifting Per Stroke	mm(in.)	11.6(0.5)
Drum Size		55 gallon, 85gallon
Net Weight	kb(lb.)	100(220)